

CONTRACTION JOINT

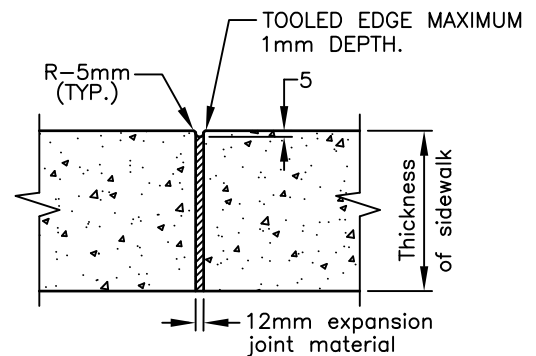

EXPANSION JOINT

NOTES:

1. FOR WALK ADJACENT TO CURB SEE DRAWING OS-303.
2. WHERE CONSTRUCTION DRAWINGS STIPULATE REINFORCED SIDEWALK THROUGH A DRIVEWAY SECTION, USE WELDED WIRE MESH CONSTRUCTED OF #6 GAUGE AT 150mm CENTRES.
3. COMPRESSIVE STRENGTH OF CONCRETE TO BE 32MPa AT 28 DAYS.
4. CONTRACTION JOINTS TO BE PLACED UNIFORMLY AT A MINIMUM OF 1.5m INTERVALS AND A MAXIMUM OF 2.0m INTERVALS. CONTRACTION JOINTS TO BE PLACED UNIFORMLY THROUGH DRIVEWAYS. EXPANSION JOINTS TO BE PLACED AT A MAXIMUM SPACING OF 14m AND AT BOTH SIDES OF A DRIVEWAY. ALL JOINTS SHALL BE CONSTRUCTED AS PER OPSS-351.
5. ALL SIDEWALK TO HAVE A BRUSHED FINISH, PERPENDICULAR TO THE CENTRELINE, EXCEPT FOR SIDEWALK EDGES TO BE TOOLED PARALLEL TO SIDEWALK.
6. ALL PERPENDICULAR TOOL MARGINS FROM FINISHING TOOLS FOR EXPANSION JOINTS ARE TO BE BROOMED OUT SO THAT NONE EXIST.
7. ALL CONTRACTION JOINTS ARE TO BE SAW CUT; TIMING OF SAW CUTTING PROCEDURE AS APPROVED BY THE FIELD WHERE SIDEWALK ABUTS EXISTING BUILDING OR STRUCTURE A 10mm EXPANSION JOINT IS REQUIRED.
8. **4% SIDEWALK CROSSFALL MAY BE PERMITTED AT THE DISCRETION OF THE CITY OF OSHAWA.
9. MEASUREMENTS IN METRES AND/OR MILLIMETRES UNLESS OTHERWISE SHOWN.

CITY OF OSHAWA

CHK'D: *S.L.*

APP'D: *S.L.*

DATE: MARCH 2023

SIDEWALK SECTION

REVISION No. 7

DATE: MARCH 2023

OS-301