

NOTE: DOWELS ONLY TO BE USED WHERE/WHEN SPECIFIED ON THE CONSTRUCTION DRAWINGS

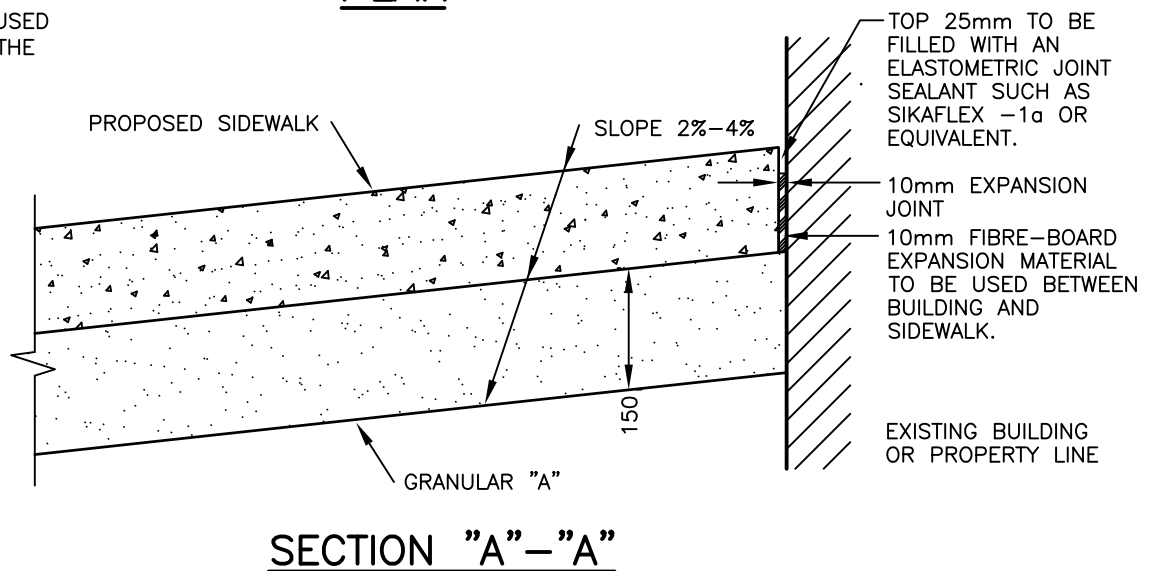

NOTES:

1. FOR ADDITIONAL SIDEWALK INFORMATION REFER TO DRAWINGS OS-301, OS-303 AND OS-304
2. DOWELS TO HAVE A MINIMUM OF 50mm OF COVER
3. MEASUREMENTS IN METRES AND/OR MILLIMETRES UNLESS OTHERWISE SHOWN.
4. DOWELS TO BE ADDED ONLY IF DIRECTED BY THE CITY OF OSHAWA.

CITY OF OSHAWA

CHK'D: *J.J.*

APP'D: *L.H.*

DATE: FEB 2, 2022

**SIDEWALK SECTION
ABUTTING BUILDINGS**

REVISION No. 3

DATE: FEB 2, 2022

OS-302