

Pool Contractor: Being Installed By Owner

Business Owner Name: _____

Business Address: _____

No. Street City Postal Code

Phone No. (Res / Mobile / Bus)

Pool Enclosure Details:

Type of Fence Wrought Iron /Metal Chain Link Wood Board Other

Height of Fence 1.5m (5 ft) 1.6m (6 ft.) 2.2m (7.2 ft)

Gates No. of Single Gates _____ No. of Double Gates _____

Door Access - Garage to Pool Yes No

Enclosure adjacent to driveway / street Yes No

Applicant:

The undersigned; hereby applies for a Pool Enclosure Permit in accordance with the plans and specifications submitted with this application, further acknowledges that the work must comply with the provisions of the Pool Enclosure By-law as amended from time to time, and further understands and acknowledges that neither the issuance of a Pool Enclosure Permit nor the carrying out of inspections by the City shall relieve the applicant from the full and on-going responsibility for compliance with the applicable by-laws and regulations.

I, _____ of _____ do solemnly declare:
Name (Please Print) City

1. Check one only:
 THAT I am the property owner named in this application **OR** THAT I am the authorized agent of the property owner named in this application (Agent must submit written authorization from property owner with this Application.)
2. THAT all statements made and information supplied in connection with this application are true and factual & that I understand and consent to the condition noted above.

Applicant's Signature Date

Personal information contained on this form is collected under the authority of Section 11 of the Municipal Act, 2001 and will be used for administering the Municipal Law Enforcement and Licensing process. Questions concerning collection of personal information should be directed to the City of Oshawa's Information, Access and Privacy Officer at 50 Centre Street South, Oshawa, Ontario, L1H 3Z7 or 905-436-3311.

FOR OFFICE USE ONLY		Application Number		
	Initial	Date	Initial	Date
Application Taken By			Fee \$	
Examiner Assigned			Inspector Approval:	
Owner's Authorization			Permit Issued By:	
Clearance Letter			Issuance Date:	

Notes:

1. Pool enclosures shall comply with City of Oshawa Zoning By-law 60-94 as applicable and any other relevant By-law /Legislation, as amended from time to time.
2. It is the responsibility of the property owner to contact the Inspector noted on the permit for inspections, prior to installation/construction/upon completion of the fencing/upon completion of the gate(s) and any remedial work.
3. The construction of a pool enclosure must be completed **within four (4) months of the date of permit issuance.**

Personal information contained on this form is collected under the authority of Section 11 of the Municipal Act, 2001 and will be used for administering the Municipal Law Enforcement and Licensing process. Questions concerning collection of personal information should be directed to the City of Oshawa's Information, Access and Privacy Officer at 50 Centre Street South, Oshawa, Ontario, L1H 3Z7 or 905-436-3311.

ADDRESS: _____ Oshawa, Ontario

OWNER: _____

Fill in details on this site plan (or preferably on a copy of a plan of survey) such as pool setbacks, enclosure location, location of gates and location of permanent climbable objects on neighbouring properties, etc.

SITE PLAN (NTS)

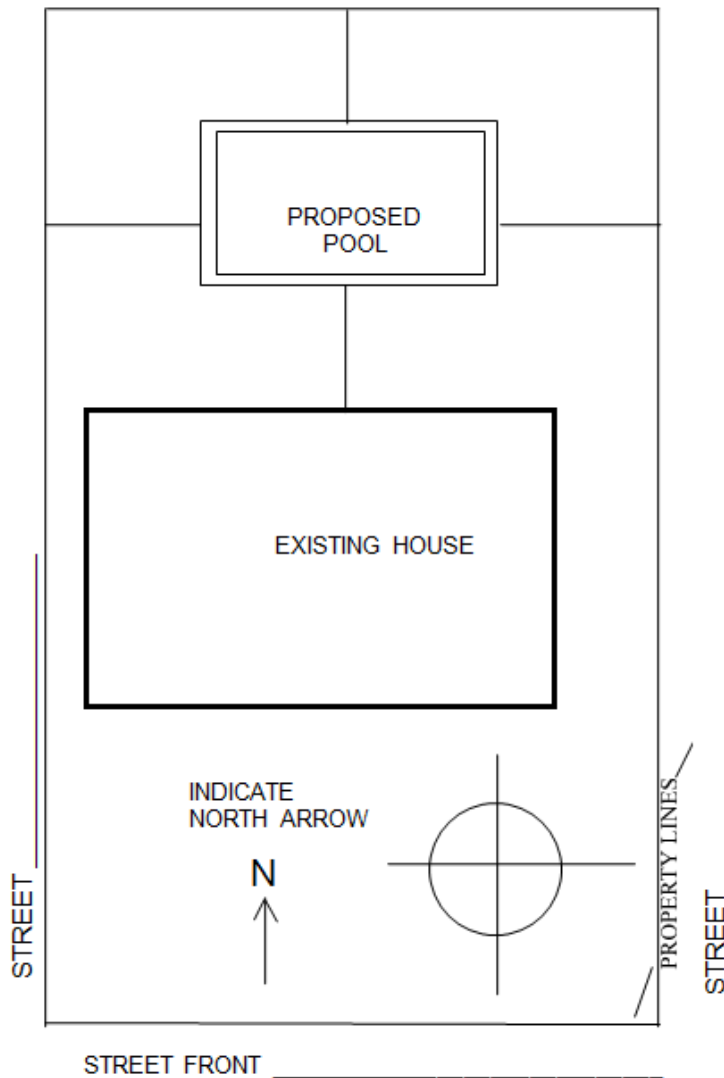

TYPE OF PROPOSED FENCE:

- Chain link fence (for details refer to Pool Enclosure By-law No. 79-2006 - table 5.2.3.A)
- Wood Fence (for details refer to Pool Enclosure By-law No. 79-2006 - table 5.2.1.A)
- Metal Fence (for details refer to Pool Enclosure By-law No. 79-2006 - table 5.2.2.A)
- Other (submit details and refer to Pool Enclosure By-law No. 79-2006 - Article 5.3.5)

Symbols:

- ⇐ main house entrance
- ← other house entrance(s)
- ≡ gates in enclosure
- ≡ enclosure (fence)
- ⊙ corner of lot
- ⊠ required parking space in side yard

Type of Lot (check one)

- Interior lot (facing only one street)
- Corner Lot (facing more than one street)

Personal information contained on this form is collected under the authority of Section 11 of the Municipal Act, 2001 and will be used for administering the Municipal Law Enforcement and Licensing process. Questions concerning collection of personal information should be directed to the City of Oshawa's Information, Access and Privacy Officer at 50 Centre Street South, Oshawa, Ontario, L1H 3Z7 or 905-436-3311.

POOL ENCLOSURE PERMIT INFORMATION

This information is provided for convenience only. Reference to Pool Enclosure By-law No. 79-2006 should be made for accurate interpretation.

1) POOL ENCLOSURE PERMIT REQUIRED

A Pool Enclosure Permit is required for all Pool Enclosures, within the City of Oshawa, which contain a pool, hot tub, or decorative pond with a depth of 60 centimetres (24 inches) or more. An application form must be fully completed and signed by the owner or his/her authorized agent and must be accompanied by the required permit fee, a clearance letter from Engineering Services and Permit plans for review.

Permit plans must show the proposed location of the swimming pool in relation to the proposed enclosure, lot lines and adjacent buildings. Complete dimensions of the swimming pool enclosure must be shown, including materials, gate and panel design and construction. Attachment #1 to this information sheet is a sample plot plan that you may use this to provide information or you may use this as a template to create your own plot plan. A copy of an up-to-date plan of survey of the property showing the pool location is helpful and should be submitted, where possible.

2) PERMIT FEE

A fee of \$200.00 must be paid at the time of the application. Personal cheque payable to the "City of Oshawa", cash, money order, Interac®, Visa, Master Card or Amex payments are acceptable methods of payment. The permit fee is non-refundable and the permit is only valid for four (4) months from the date of issue.

3) REQUIRED POOL ENCLOSURE (FENCING)

Any body of water located outside of a building contained in whole or in part by artificial means in which the depth of water at any point can exceed 0.6 metres (24 inches) requires a pool enclosure permit. This applies to **swimming pools, hydro massage pools, hot tubs, spas, whirlpools and decorative ponds**. A pool enclosure (fence) must be a minimum of **height not less than 1.5m (5 ft.)**. **The 1.5m (5 ft.) height requirement for Pool Enclosures is also applicable to any above ground pool including inflatable pools when their depth can exceed 0.6 m (2 ft.)**.

(a) CHAIN LINK FENCE

1.5 m (5 ft.) high Chain link fences must be constructed of not greater than 40mm (1½") diamond mesh. All fencing components must meet or exceed the minimum size, spacing and installation requirements as specified in By-law 79-2006.

Personal information contained on this form is collected under the authority of Section 11 of the Municipal Act, 2001 and will be used for administering the Municipal Law Enforcement and Licensing process. Questions concerning collection of personal information should be directed to the City of Oshawa's Information, Access and Privacy Officer at 50 Centre Street South, Oshawa, Ontario, L1H 3Z7 or 905-436-3311.

(b) WOOD FENCE

Wood fences must be constructed of vertical boards, min. 19 x 89 mm (1" x 4"), with max. 100mm (4") spaces unless otherwise approved. All structural fencing components must meet or exceed the size, spacing and installation requirements as specified in By-law 79-2006. **Note: "FENCE SPIKES" are not permitted for use with wooden fence posts.**

(c) METAL FENCING

Wrought iron or similar fencing must be a minimum height of 1.5m (5 ft) with vertical members spaced no more than 100mm (4") apart. A 0.3m (12") x 0.3m (12") plate must be provided over the gate latch to prevent access to the latch.

(d) OTHER POOL ENCLOSURE FENCES

Other types of fences may be permitted, however, they must also comply with the By-law in that they must be rigid, non-climbable and provide an equivalent degree of safety. Design specifications of the new proposed fence must be examined for compliance prior to construction.

4) WATER IN POOL

Water may not be placed in any pool until the enclosure, prescribed by By-law 79-2006, has been erected and inspected and approved by the City. Temporary fencing may be provided subject to compliance with this by-law. Speak to the inspector assigned to your file/permit.

5) LOCATION OF FENCE IN RELATION TO PERMANENT CLIMBABLE OBJECTS

Pool enclosures must be located a min. 0.9 m (35.4") from any permanent climbable object located on the outside of the pool enclosure, unless otherwise specified in the By-law.

6) DOORS AND GATES

Doors leading from a building (attached or detached garage) directly to an enclosed pool and gates forming part of a pool enclosure, must be equipped with self-closing (spring loaded) devices and with lockable self-latching devices located on the top and on the inside of the gate (see attached sample) and for doors, must be located 1.5m (5 ft.) above the bottom of the door as specified in the By-law. It is preferable that gates swing in towards the pool area.

7) ZONING RESTRICTIONS

Privately-owned outdoor swimming pools may not be located in a front yard of a property.

8) EXEMPTION FOR HOT TUBS, WHIRLPOOLS AND SPAS

Neither a Pool Enclosure or Pool Enclosure Permit are required if a lockable 2" thick affixed cover capable of holding 90.72kg (200 lbs) is kept locked when not in use.

Personal information contained on this form is collected under the authority of Section 11 of the Municipal Act, 2001 and will be used for administering the Municipal Law Enforcement and Licensing process. Questions concerning collection of personal information should be directed to the City of Oshawa's Information, Access and Privacy Officer at 50 Centre Street South, Oshawa, Ontario, L1H 3Z7 or 905-436-3311.

OTHER APPROVALS

The applicant is responsible for obtaining the approvals or a permit from other agencies, where applicable, prior to the issuance of a permit.

- Central Lake Ontario Conservation Authority (C.L.O.C.A.)
100 Whiting Avenue, Oshawa L1H 3T3, Tel. (905) 579-0411 Fax: (905) 579-0994
Re: construction in flood plain, placing of fill in restricted areas.
- Ministry of Transportation (MTO)
1201 Wilson Avenue, Downsview M3M 1J8, Tel: (416) 235-5385 Fax: (416) 235-5276
Re: for properties directly abutting Highway #401 or an interchange thereof.
- City of Oshawa Engineering Services
9th floor Rundle Tower, 50 Centre Street S, Oshawa, Tel: (905) 436-3311 ext 5606
Fax: (905) 436-5694

Re: for pool installations which require digging, consult Engineering Services regarding Site Alteration Permit requirements.

Note: All electrical connections must be approved by Electrical Safety Authority.

Tel: 1-877-372-7233

INFORMATION

For further information, contact: The City of Oshawa, Corporate Services Department, Municipal Law Enforcement & Licensing Services (Municipal Licensing and Standards), at 50 Centre Street South, Oshawa L1H 2Z7 Tel: (905) 436-3311 ext 2299, or 1-800-6-OSHAWA, Fax: (905) 436-5683, E-Mail: lic_stand@oshawa.ca

Sample Self-Latching Device

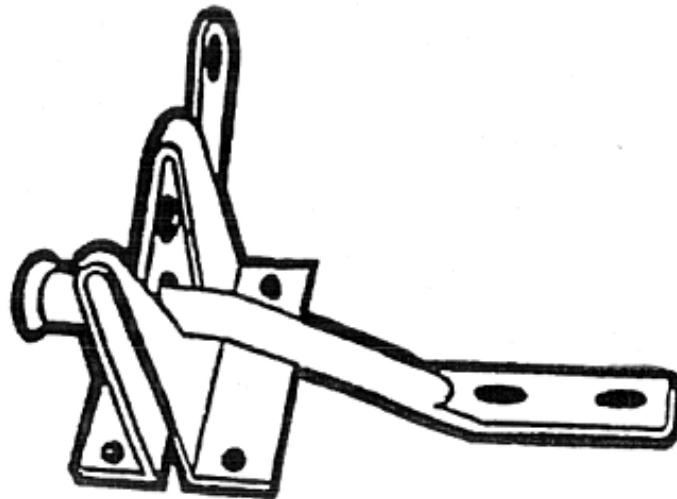

Personal information contained on this form is collected under the authority of Section 11 of the Municipal Act, 2001 and will be used for administering the Municipal Law Enforcement and Licensing process. Questions concerning collection of personal information should be directed to the City of Oshawa's Information, Access and Privacy Officer at 50 Centre Street South, Oshawa, Ontario, L1H 3Z7 or 905-436-3311.